



**KENTUCKY COMMUNITY AND TECHNICAL COLLEGE SYSTEM
Invitation to Bid ADDENDUM**

BID NO.: KCT-01445
ADDENDUM NO.: 1
BID ISSUE DATE: April 16, 2026
ADDENDUM DATE: April 23, 2026
OPENING DATE: May 1, 2026
TITLE: Moving Services

The following information is provided in response to questions submitted by potential bidders:

1. Additional documents shall be added to this bid for informational references:
 - a. Science Building Moving Map – see attachment
Moving Inventory – see attachment
2. Where will the layout of the rooms with amounts of items be listed? I can't seem to find this in the portal.
 - a. Please see the attachments to this addendum for maps and inventory.
3. Can we leave a trailer on site for additional storage if everything does not fit in the auditorium? Will there be somewhere on the proposal for this?
 - a. This solicitation is for moving services only. Elizabethtown Community & Technical College has storage options available if storage is necessary.

The time to submit questions for this Invitation to Bid has expired.

Bidders must acknowledge receipt of this and any addenda either with solicitation or by separate letter or email prior to award of contract. If by separate letter, the following information should be placed in the lower left-hand corner of the envelope:

Bid No.: KCT-01445
Title: Moving Services

Name of Firm: _____

Authorized Signature: _____

SCIENCE BUILDING

First Floor

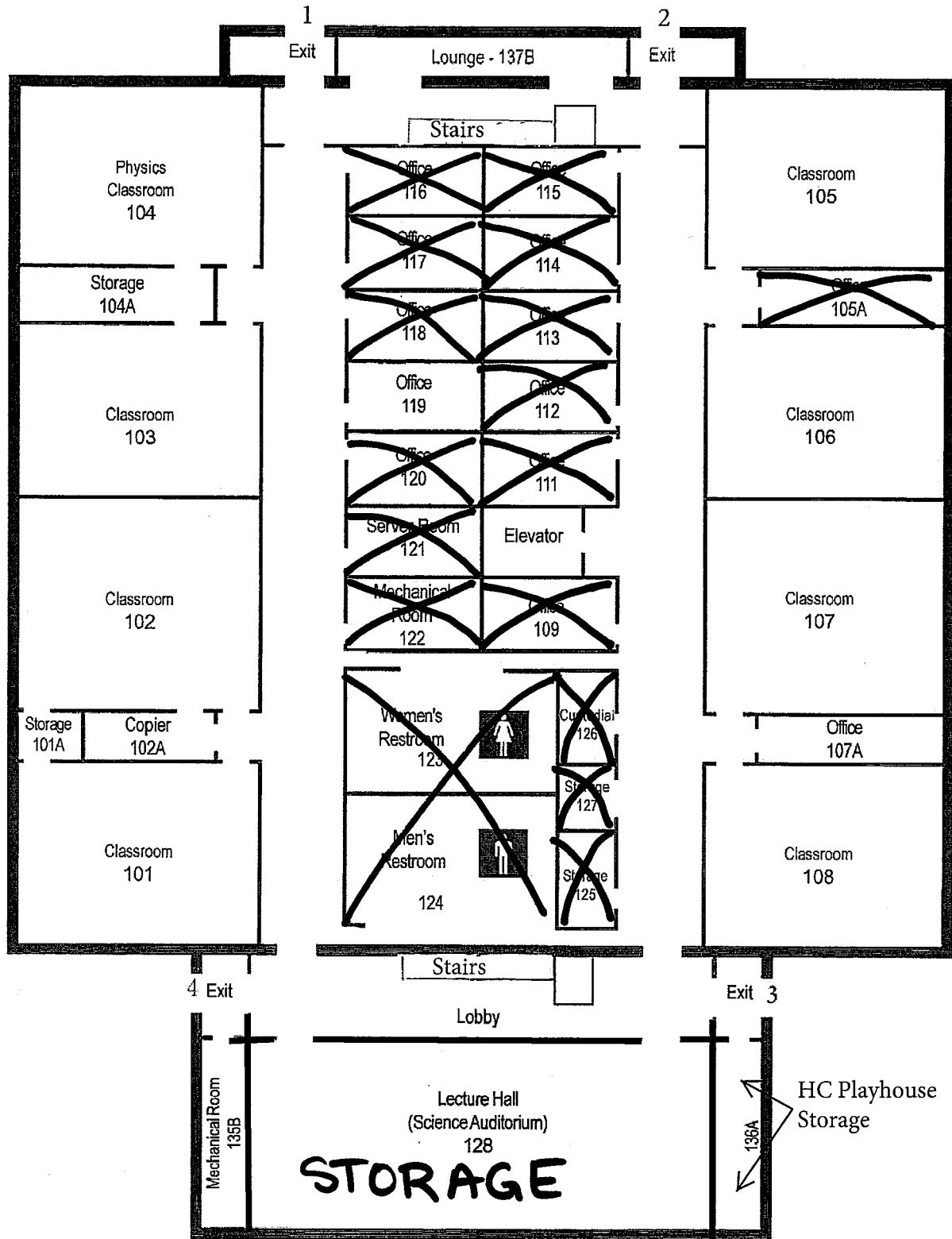

SCIENCE BUILDING

Second Floor

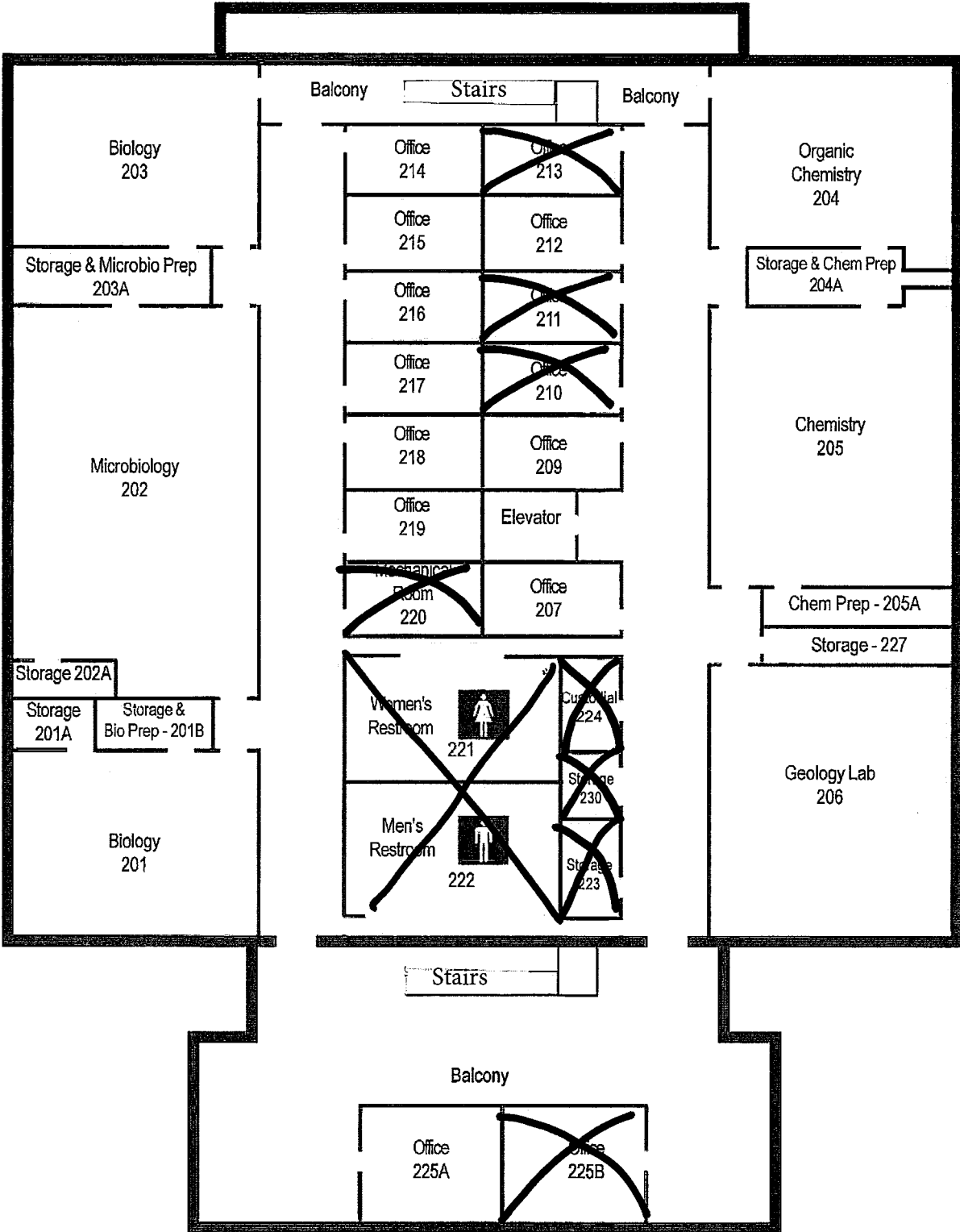

Instructor Name:

Tiffany McFalls & Gail Haycraft

SCI Room #: 225A, 201 & 201 workbook

Item Description	Currently	Relocate to EHMS Rm #	Move to Storage	GovDeals	Scrap	Trash	Asset?/Tag #
Instructor Desk	225A	EHMS 724					
/tables (2)	201	EHMS 109					
Instructor Chair (2)	225A	EHMS 724					
Instructor Chair (2)	201	EHMS 109					
Wall shelving	225A		SCI Auditorium				
Book Shelves (3)	201	EHMS 111					
File Cabinet	225A	EHMS 203					
File Cabinet	201	EHMS 723					
Storage Cabinet 2 door	225A	EHMS 111					
Table -Science tables (3)	201	EHMS 111					
Student Tables (7)	201	EHMS 111					
Student Stools (28)	201	EHMS 111					
Top shelving w/Glass Doors (8)	201	EHMS 113					
Goggle Cabinet	201	EHMS 110					
BioSafety Cabinet	201	EHMS 111					
Refrigerator	201	EHMS 111					
Rolling metal carts (3)	201	EHMS 111					
Eyewash station-portable	201	EHMS 110					
Lg Red Bins (5)	201	EHMS 111					
Refrigerators (1)	Hallway	EHMS 105					
Wood Storage Cabinet	201	EHMS 111					

Notes:

Need portable eyewash stations for all labs; set up with Cintas

They'll move own models and microscopes

Take large rolling white board and 1 black metal cabinet from RPC 234/235 to EHMS 201

Take small rolling white board from RPC 234/235 to EHMS 110

Instructor Name:Doug Cochran & Joe Wolf

SCI Room #: 202, 203A, 217, 215

<u>Item Description</u>	<u>Currently</u>	<u>Relocate to EHMS Rm #</u>	<u>Move to Storage</u>	<u>GovDeals</u>	<u>Scrap</u>	<u>Trash</u>	<u>Asset?/Tag#</u>
Instructor Desk	217	102					
Instructor Desk	217	102					
Instructor Chair	215	101					
Instructor Chair	215	101					
Bookcase	217	101					
Bookcase	215	101					
Bookcase	202	101					
File Cabinet	217	101					
File Cabinet 2	215	101					
Storage Cabinet -rolling	203A	101					
Storage Cabinet -fire	203A	101					
Storage Cabinet -fire	203A	101					
Table -Science Tables (7)	202, 203A	101					
Table -Folding (3)	203A, hallway	101					
Student Stools (24)	202	102					
37 degree Incubator	202	102					
55 degree Incubator	202	102					
Freezer	202	102					
Centrifuge	202	102					
UV Goggle Cabinet	202	102					
30 degree Incubator	202	102					
Still for water	202			X			
BioSafety Cabinet	203A	101					
Refrigerator	203A	101					
UV Cabinet	203A	102					
37 degree Incubator	203A	102					
42 degree Incubator	203A	101					
Metal Two-tier Shelf	203A	101					
Rolling metal carts (6)	202 & 203A	102					
Refrigerators (2)	Hallway	101					

Instructor Name:

Tiffany McFalls & Gail Haycraft

SCI Room #: 203

Item Description	Currently	Relocate to EHMS Rm #	Move to Storage	GovDeals	Scrap	Trash	Asset?/Tag #
Table 1-Science Tables (4)	203	EHMS 109					
Student Tables (6)	203	EHMS 109					
Student Stools (26)	203	EHMS 109					
Hot Water Bath	203	EHMS 111					
Goggle Cabinet	203	EHMS 111					
Rolling metal carts (1)	203	EHMS 111					
Display cabinets in lobby (4)	hallway near 225		SCI auditorium				
Plant terrarium	hallway near 203		SCI auditorium				
Eyewash station-portable	203	EHMS 111					
Top glass front shelving	203	EHMS 109					

Notes:

Need portable eyewash stations for all labs; set up with Cintas

They'll move own models and microscopes

Bring fire extinguishers, paper towel dispenser, trash cans, clocks (if they will work)

Instructor Name:

Jerianna LaPorte

SCI Room #: 204 & 204A

Item Description	Currently	Relocate to EHMS Rm #	Move to Storage	GovDeals	Scrap	Trash	Asset?/Tag #
Biohazard Frig/Freezer	204	202					
Ice Maker	204	202					
Misc Chairs and old stools	204				X		
Stools (3)	204		X				
Black top table	204		X or Scrap				
Small Wooden Table	204		X				
Fume Hoods (3)	204			X			
Fume Hoods - inset (3)	204			X			
Marble Table	204		X				
Rolling step ladder	204A		X				
Incubator Oven	204A				X		
Acid Cabinet - blue	204A	202					
Yellow Cabinet - Tall	204A				X		
Yellow Cabinet - short	204A	202					
Rolling Carts (3)	204A	1-202		2			
Black top table	204A		X				
Silver Lab Oven	204A	202					
Stool	204A		X				

Instructor Name:

Lobby areas & Outdoors

SCI Room #:

Item Description	Currently	Relocate to EHMS Rm #	Move to Storage	GovDeals	Scrap	Trash	Asset?/Tag #
3 High top tables	Lobby-ATB side	We will relocate ourselves to: ?					
6 Stools	Lobby-ATB side	We will relocate ourselves to: ?					
Vending Machines	Lobby-ATB side	Vendor will move these themselves					
Couch	Lobby-JSO side	EHA					
Ottoman	Lobby-JSO side	EHA					
End Tables (3)	Lobby-JSO side	EHA					
Bar w/4 stools	Lobby-JSO side	EHA					
Couch desk/tables (2)	Lobby-JSO side	EHA					
Plants	Lobby-JSO side	EHA					
Red benches (8)	Courtyard			X			
Grey Tables w/black seats (7)	all around SCI	We will relocate ourselves to: ?					
Solar Tables (3)	Courtyard	We will relocate ourselves to: ?					
Black Table w/4 bench seats	Parking area	We will relocate ourselves to: ?					
Red table w/4 bench seats (2)	all around SCI			X			
Tan & Stone benches (2)	By road/parking			X			